



OAGH-43 Steel or Aluminium Trawler Yacht Specifications



Main Dimensions:

L.O.A.	43'10"	13.36m
L.W.L	36'08"	11.18m
Beam	15'00"	4.57m
Draft	5'00"	1.52m
Fuel	700 gal	2,650L
Water	150 gal	570L
Displ.:	43,900 lbs	
Cruising speed:	10 knots	
Max Speed	15 knots	
Range:	Approx 1,000nm	
Range with wing engine:	Approx 2,000nm at 8 knots	

Ocean Asia Inc Ltd

Tel: (+852) 9090-2767

Email: info@ocean-asia.com

Web: www.ocean-asia.com

Steel Construction

- Steel construction : Marine grade steel
- Three (3) section of watertight bulkhead.
- Rudder: 1¾" SS stock, ¼" SS plate rudder.
- Cabin room and Saloon : Insulated by 'Urethane Foam'
- Engine Room : Natural rotation ventilation system
- Topsides: Finished with Urethane paint.
- Under body: Coated with quality copper-based antifouling paint.

Engine System

- Main Engine : 225 HP Perkins-Sabre, 2500rpm, 80-amp 12V alternator, 1:1 gear driver
Wing Engine : 86HP Perkins-Sabre, 2400rpm, 80-amp 12V alternator, 1:1 gear driver.
- Stainless steel shaft (type 316) They are to be a polished a main propeller (three(3) blades) and auxiliary folding propeller.
- Cycle & Cylinder : 4 Stroke in line
- Intake system : Turbo charger, after-cooled
- Exhaust system : Flexible fitting, muffler
- Cooling system : Expansion tank, heat exchanger
- FO system : Primary fuel filter, flexible fuel line, fuel cooler
- LO system : Gear driven LO pump
- Control system : Electric engine control, W/H alarm panel, engine mounted instrument panel
- Starting system : DC 12Volt electric starting motor

220 or 110 VAC Electrical System

- Generator : 8kW fisher Panda 50/60Hz
- One 30-amp shore power inlets and 50 ft. cord
- Freedom 12/2500W 100-amp inverter/charger combination
- Illuminated main circuit breaker distribution panel
- 220 or 110 V outlets in engine room, in all cabins, salon, and aft deck
- 220 or 110 V GFI outlets in head

24 V Electrical System

- Toilet attached pump
- Windlass
- Bow thruster

12 V Electrical System

- Nine(9) 200-amp Hour marine batteries
 - Four(4) starting batteries, Two(2) thruster batteries, Three(3) house

Ocean Asia Inc Ltd

Tel: (+852) 9090-2767

Email: info@ocean-asia.com

Web: www.ocean-asia.com



batteries.

- Engine and main battery switch in lower station cabinet
- Illuminated main circuit breaker distribution panel
- Navigation switch panel at lower helm station
- Battery condition gauge
- 12 V lighting system
- 12 V horn
- 12 V pressure water system
- Navigation lights-side lights, 360 degree light and stern light
- Step command bridge courtesy lights
- Deck lights
- 12 V amperage gauge
- All kinds of pump 12V

Pilot House

- Ignition key and instrument panel
- Digital tachometer
- Gauges for voltmeter, engine and transmission oil pressure, block cooling water temperature fuel level
- Audible alarm for main engine
- Glendenning lever model EEC1000 controls
- Horn button
- 5 inch Ritchie compass
- High intensity portable searchlight
- Navigation light and control switch panel

Ocean Asia Inc Ltd

Tel: (+852) 9090-2767

Email: info@ocean-asia.com

Web: www.ocean-asia.com

Main Salon

- Main electrical distribute panel and three(3) batteries, inverter/charger combination
- Settee converts to double berth, fixed foam cushions
- Locker storage under settee
- High-low yacht table
- 220 V outlets
- Couch converts to single berth with drawers below

- Galley

- Spacious Formica galley counter
- Double stainless steel sink with faucet
- Hot and cold water
- Storage below counter and overhead lockers
- 220 V outlets



- Four-burner propane stove
- Sliding window with screen
- Teak flooring

Deck

- Handrail : 1.26" and 1.00" stainless steel (type 316)
- Stainless steel bow pulpit with anchor roller and 30kg. "Clow" anchor

Ocean Asia Inc Ltd

Tel: (+852) 9090-2767

Email: info@ocean-asia.com

Web: www.ocean-asia.com

- Rope locker
- Recessed side deck walkways
- 2" sliding door with sliding screen window to main salon
- 1" perimeter stainless steel guard rail on command bridge
- Sliding windows starboard and port with screens
- Courtesy lights on boarding steps, swim platform
- Flag pole holder and pole

Fresh Water System

- S.S. water tank 150 gal. capacity with valves
- JEM Marine Water Heater 22ℓ, hot water heater 220 V or Engine cooling water.
- Johnson automatic pressure water system with pressure storage tank, 12 V with filter
- 12 V osmotic pressure water maker

Fuel System

- Two SS fuel tanks, 700 gal. total
- Racor 500 F.G. fuel filter and water separator
- SS deck fill plates two(2) position (Labeled)
- Crossover fuel manifold and valves

Steering System

- LS France Hydraulic 1 power steering systems; one(1) position control stations
- Stainless steel rudder

Main Cabin

- Cabinet
- Air-conditioner
- Bow thruster
- Two(2) batteries
- Two(2) portlights
- Two(2) hatches
- 220 V outlet

Guest Cabin

- Engine process control unit
- Four(4) batteries
- Cabinet
- One(1) portlights
- 220V outlet
- Latex mattress on double berth

Ocean Asia Inc Ltd

Tel: (+852) 9090-2767

Email: info@ocean-asia.com

Web: www.ocean-asia.com

Bath Room

- Shower
- One(1) sink, One(1) toilet
- 220V outlet

Waste Disposal System

- 50 gal. fiberglass holding tank
- Manual Marine head pump
- Overboard discharge controls in head
- 12V Johnson pump and overboard discharge



Bilge System

- Overboard discharge controls in head
- Three(3) bilge pump by floating switch type
- Submersible pump (Johnson)

Options

- Flybridge helm station
- Radar – Autopilot – GPS – Plotter – Fish Finder
- VHF radio
- SSB radio
- Weatherfax
- LCD TV in saloon and cabins
- Reverse cycle Air-conditioning

NB. These specifications may be altered by the builder without warning and should not be used to form part of any contract, unless mutually agreed by the builder and the purchaser.

Ocean Asia Inc Ltd

Tel: (+852) 9090-2767

Email: info@ocean-asia.com

Web: www.ocean-asia.com

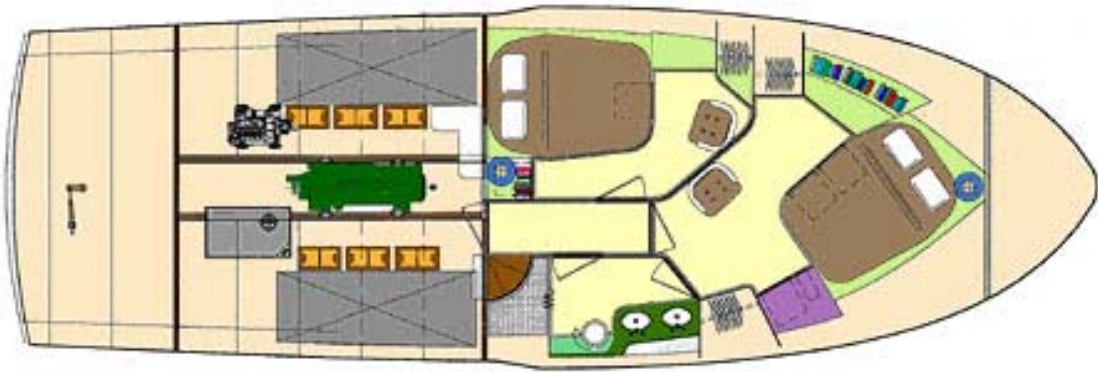
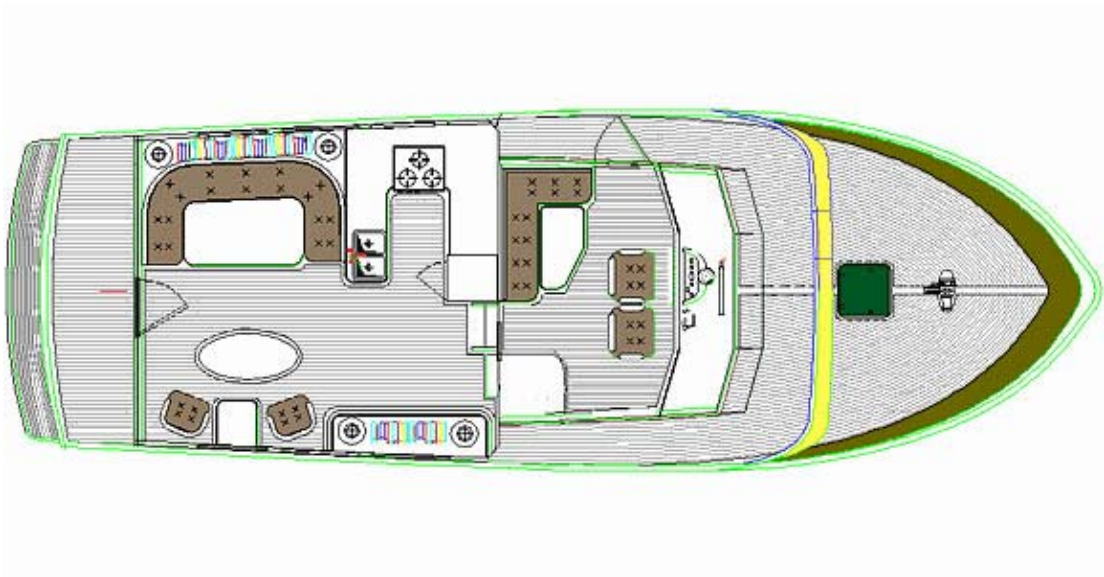

Ocean Asia Inc Ltd

Tel: (+852) 9090-2767

Email: info@ocean-asia.com

Web: www.ocean-asia.com