



OAI-386 Sedan Trawler Yacht



SPECIFICATIONS

Length Overall:	_____ 38' 5.81"	11.73m
Beam:	_____ 12' 11.90"	3.96 m
Length of Waterline:	_____ 35' 4.01"	10.77m
Draught (approx.):	_____ 3' 11.64"	1.21m
Fuel Capacity:	_____ 450 US Gal.	1700 litres
Water Capacity:	_____ 250 US Gal.	950 litres

Built to ABYC and ABS as standard

STRUCTURE

- * Modified "V" hull design.
- * Hand laid GRP solid skin below waterline, vacuum-bagged honeycomb core sandwich structure for hull side shell above water line.
- * Longitudinal stringers and transverse frames system.
- * Three watertight bulkheads.
- * Hull and deck joint sealed by glue, bolted and laminated with mat and woven roving.
- * Grey or black water holding tank, or combined holding tank, fitted as standard.

Ocean Asia Inc

Email: info@ocean-asia.com

Website: <http://ocean-asia.com>

STANDARD EQUIPMENT

MECHANICAL

- * Single or dual Cummins 210hp Diesel engine complete with engine instrumentation gauges at each helm station including key start (lower only) and engine overheat & low oil pressure alarms. Dual engine configurations available.
(Trim tabs fitted as standard for engines above 2 x 150 hp.)
- * GRP drip pan under main engine.
- * Stainless steel or Aquamet propeller shaft 1.75" (44.5mm) turning inside two cutlass bearings.
- * P.Y.L. Dripless stern gland for engine shaft 1.75" (44.45mm)
- * 4 blade bronze propeller with double lock nut and stainless steel split pin system.
- * Rudder fibreglass blade/stainless steel shaft.
- * Hydralift wet box muffler with built-in drain cock.
- * Hydraulic steering system.
- * Engine room 12V DC 3" blowers & natural air intake vents (2).
- * Superior engine room sound proofing material with perforated aluminium fascia and hatch seal.
- * Rule or equivalent 12V DC 1500 GPH electric bilge pumps with float switches and manual/auto switching electrical panel. (2)
- * Manual bilge pump.
- * Fuel management system including by-pass and dedicated fuel shut-off valves.
- * Morse engine throttle & gear box control system at main helm station: model MT3 single.
- * Sea cocks on all through hull fittings at or below water line. (Double hose clamped).
- * Fuel tankage black iron with two hand-hole clean out ports, sight gauges, sump and breathers (2).
- * Water tankage 304 grade welded stainless steel with sight gauge, breather and hand-hole clean out ports.
- * Bronze basket type internal sea water strainer for main engine.
- * Racor fuel filter unit for main engine.
- * 12 gallon 120/240V AC dual heating hot water heater tank system.
- * Jabsco, Johnson or Raritan 12VDC electric pressurized fresh water pump ± 3.8 GPH flow rate with accumulator tank.
- * Transom hot and cold fresh water shower.

HARDWARE

- * Stainless steel anchor roller assembly.
- * Stern and mast head flag-staffs in teak with stainless steel base and lock nut.
- * Cleat 12" Heavy Duty type – 2 bow, 2 midship, 2 aft in stainless steel (6).
- * Door lock with key on saloon entrance door. Door unit in stainless steel.
- * Horn 12V DC – mounted on main cabin roof: switch located at main helm.
- * Deck rails – 1.25" stainless '316 steel' tubing.
- * 12V DC Double arm wipers to port, midship and starboard front windscreens with fresh water wash-down system.
- * 12V DC accommodation ceiling lights throughout, recessed into headlining.
- * Cabin door locks in stainless steel.
- * Windows are aluminium framed with insect screens. Selected windows slide.
- * Aquasignal international navigation lights.
- * Brass 12V DC reading lights in owners cabin with individual switches (2).
- * Fibreglass Platform with non-skid floor and stainless steel "D" section rubbing strake.
- * Recessed Zinc anodes to be mounted at the outside of the underwater part of the hull.
- * Transom hot and cold water shower.
- * 4 Step Folding swim ladder.
- * Stainless steel radar arch and rub rails.

ELECTRICAL SYSTEM & COMPONENTS

- * Westerbeke diesel generator 5KW 110 VAC 60Hz, complete with sound shield, muffler & fresh water cooling & separate 150 AMP hour starting battery in FG battery box.
- * Newmar automatic battery charger (or similar) in 120/240V AC including built in AMP meter & circuit breaker.
- * Two heavy duty 200 AMP hour engine starting & lighting batteries in fibreglass battery boxes with lids. Batteries parallel for starting.
- * All wiring colour coded & numbered.
- * All cables run in conduit with sufficient spare space to allow for additional services.
- * Engine hour, volt and water temperature meter at helm station. Key start in engine panel set including back lighting.
- * Customized electrical panel utilizes circuit breakers and is fitted with a ship to shore switch, back lighting, integrated AC and DC volt/AMP meters, polarity indicator light and concealed behind a lucite door.
- * 120/240V AC electrical outlets to saloon, galley, master cabin, head and engine room.
- * Ship to shore 30 AMP dock side inlet fitting mounted aft starboard side at deckhouse, includes integrated galvanic isolator.
- * Copper bonding strap with ground cable attachment for each through hull fitting.
- * Electric horn.
- * Stereo speakers in each cabin with TV wiring to overhead location.
- * Compass at helm station.

FLYBRIDGE

- * Helm station forward to starboard with slide type swivelling helm seat.
- * "U" shaped settee to port with fixed table.
- * Storage in Flybridge brow.
- * Non skid deck.
- * 26" stainless steel steering wheel.
- * Clear plexiglass windscreen with stainless steel grab rail.
- * 12V DC outlet for accessories.
- * 1" (25.4mm) stainless steel safety rail.
- * Deck hatch access to cockpit.
- * Main engine panel set, gear/throttle controls and horn plus trim tab buttons.
- * Bench seats with table. Vinyl cushion with closed cell foam & mesh backs on seating.

SALOON

- * Built in "L" shaped settee lounge complete with ice box plus storage space under.
 - * Dedicated space set aside for seating on the starboard side.
 - * Bar with bottle and glass storage cabinet with refrigerator under.
 - * Teak & holly sole.
 - * Daily hatch access to engine room with ladder and gas stay. All hatches removable.
 - * Helm station with steering wheel and Morse controls, plus engine instrumentation, chart locker and helm seat with storage under.
 - * Overhead electronics locker.
 - * Access door to starboard.
 - * Overhead teak grab rail.
 - * Overhead lights 12 volt DC.
 - * All furniture & bulkheads are golden Burmese teak in satin finish.
 - * Head lining White vinyl panels.
- (* Optional Hi-lo or Yacht Table.)

GALLEY

- * Teak galley unit with Corian counter top and splash back.
- * Stainless steel sink with cover & single lever swivel type faucet.
- * Seaward Princess 3 burner gas stove with oven and Xintex SA-2 gas alarm monitor panel set.
- * Norcold 541 flush mount series under counter 12V DC or 120V/240V AC refrigerator/freezer unit located behind helm seat.
- * Cabinet with shelves under counter, plus overhead dish and cup locker.
- * 12V DC 3" electric exhaust fan above stove with stainless steel plate.
- * Trash bin with lid including external access door.

MASTER STATEROOM

- * Island berth with drawers under.
- * Mattress up to 5" (127mm) with cotton cover.
- * Side shelves with bin storage under.
- * Mirror and vanity unit with drawers under.
- * Wardrobes with auto light and door lock.
- * Head lining vinyl panels.
- * Teak bulkheads & furniture.
- * Overhead lights 12 volt DC.
- * Brass reading lamps 12V DC .
- * Headliner of white acoustic vinyl.
- * Hinged entrance door.
- * Teak and holly sole.

GUEST CABIN

- * Double berth arrangement with foam mattress. Drawers under.
- * Wardrobe with hinged door and internal light.
- * Teak bulkheads with teak furniture.
- * Ceiling lights 12 volt DC.
- * Reading lamps brass 12V DC.
- * Headliner of white acoustic vinyl.
- * Teak and holly sole.
- * Hinged entrance door

HEAD /SHOWER

- * Shower stall with door.
- * Shower sole white ceramic tiles with automatic sillage system.
- * Vanity unit with stainless steel or ceramic wash basin and moulded counter top with splash back.
- * Single lever shower. Sink hot and cold fresh water faucets
- * Teak & holly sole.
- * Mirror.
- * Jabsco electric macerator head.
- * 12V DC 3" exhaust fan.
- * Moulded finish head lining & bulkheads.
- * Overhead lights 12 volt DC sealed type.
- * 20 gal moulded type holding tank with Y-valve located in engine room with Jabsco macerator pump, deck discharge outlet & remote "Full" display panel in master head.
- * Stainless steel shower curtain rod.

AFT DECK/COCKPIT

- * Non skid GRP deck.
- * Flush access hatches to Lazarette.
- * Seat with cushions and storage under.
- * Sliding door for access to saloon.

LAZARETTE

- * Access from hinging aft deck hatch.
- * Contains rudder & steering gear.
- * Two overhead lights.
- * Wet gear storage.

MISCELLANEOUS

- * All decks diamond pattern non skid finish.
- * Teak cap rails & trim. Minimum 5 coats of gloss marine varnish.
- * Teak yacht name plate and hailing port board.
- * Hull bottom anti-fouling paint.
- * All hatches in soles have gas stays fitted (including lazarette and engine room access hatches).
- * Emergency tiller (single engine only).
- * Owners' manual.

OPTIONAL ITEMS

- | | |
|--|----------------------------------|
| * Two diesel engines or engine power upgrading. | * WESTERBEKE or Onan Generator. |
| * Bow Thruster. | * Intercom system. |
| * Stainless steel anchor & anchor chains. | * Air Conditioning. |
| * LCD TV. | * DVD Player. |
| * Amplifier. | * Rudder angle indicator. |
| * Curtains. | * BBQ + Sink on flybridge. |
| * Bimini Top with stainless steel frame. | * Swim ladder. |
| * Deck wash fresh water mounted at foredeck. | * S/S or fibreglass radar arch. |
| * Jabsco search light. | * Hull colour change from white. |
| * Teak-laid cockpit, side and foredeck and/or flybridge. | * Stainless steel radar arch. |
| * Muir HRC-650 12 VDC electric windlass. | |
| * Oval Hi-Lo dining table in saloon. Folds down to form occasional double bed. | |
| * Aluminium or Stainless steel mast 10'3" with boom 8'3" hinging above the stainless steel rail. Mast to be stayed and capable of lifting 100kg. | |
| * Cherry or Sen wood finish. | |
| * Curtains. | |
| * Generator upgrade. | |
| * Teak deck on flybridge. | |
| * Teak transom. | |
| * 20 US Gal. hot water heater. | |
| * Internal engine sea water strainers. | |
| * Salt water washdown. | |
| * Hard top. | |
| * Fibreglass radar arch. | |

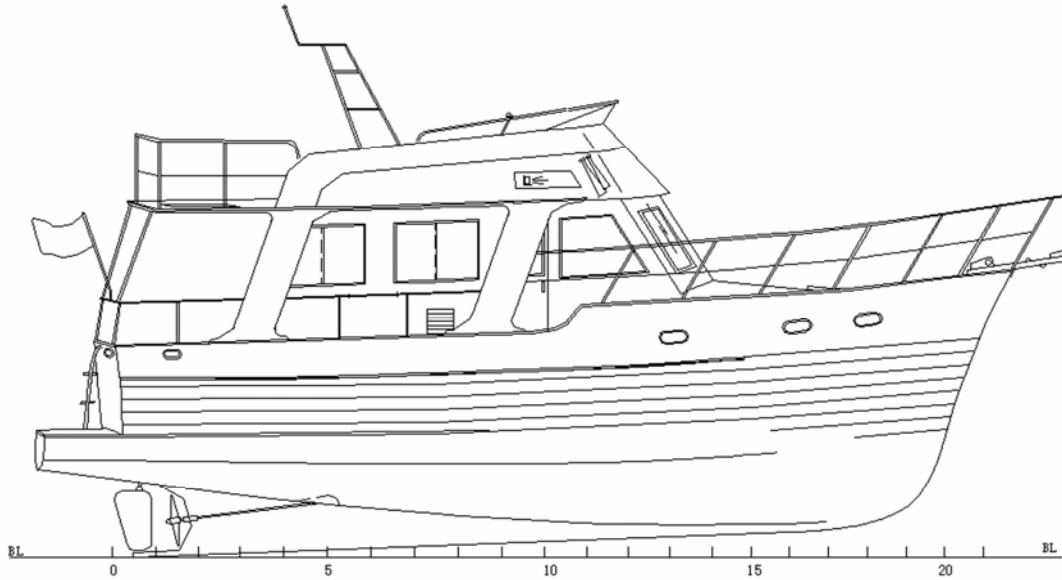

PROFILE

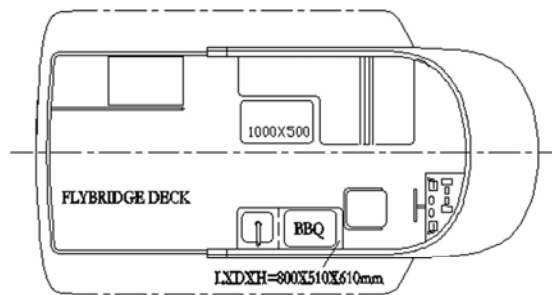

PILOTHOUSE

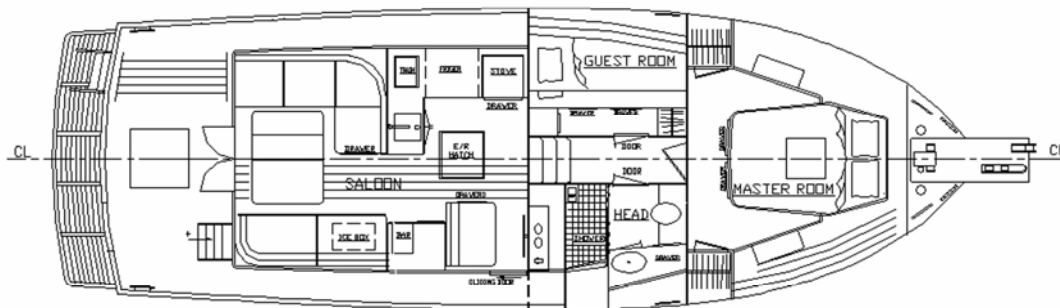

MAIN DECK